

Project Kippur A (Atonement)

Painting the roof at the church (Galvanized metal roof)

13,000 square feet

1. Supplies

- a. Paint (\$2,500)
- b. Brushes (\$300)
- c. Screws (\$1,200)
- d. Rust treatment liquid (\$300)
- e. Turpentine, gloves, cleaning supplies, + misc. (\$400)

Job scope is to remove and replace thousands of screws, rust treat some small areas that have rust, and then paint the entire roof.

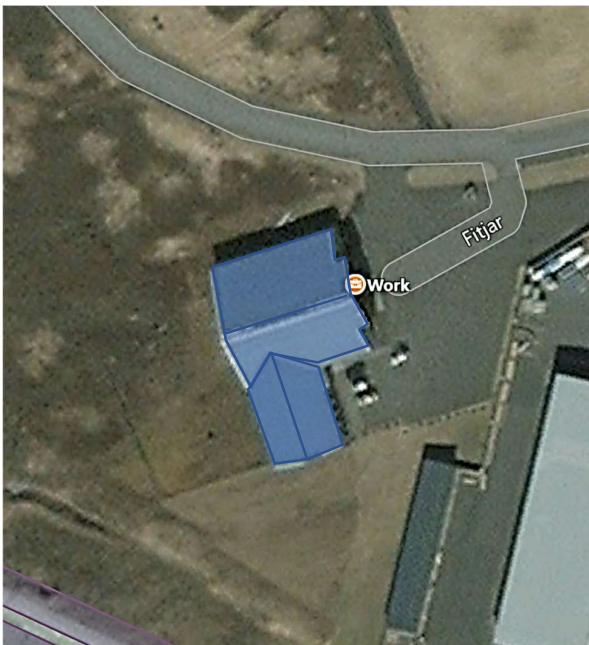

\$4,700

Project Kippur B og C (Atonement)

Job scope is to fasten 1x6 boards onto the metal framing. Fasten drywall onto the 1x6s. Insulate and drywall the main support beams.

This job is a requirement imposed by the fire inspector.

The blue and yellow zones are open spaces between the roof and the ceilings over rooms in these two zones.

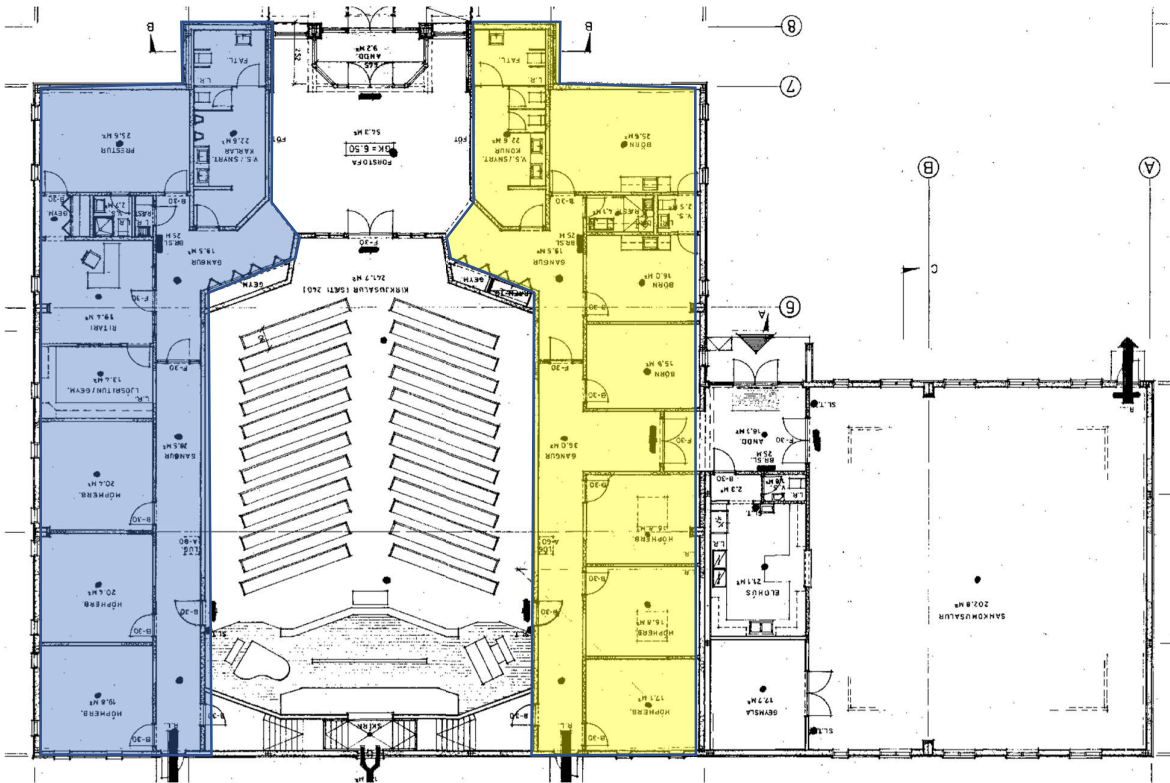

2300 square feet blue

2300 square feet yellow

\$6,000

Drywall (4'x 9.8' sheets) 70 sheets each section

Insulation needed only on support beams 550 square feet: each section.

1x6: 12 foot: Boards to fasten to metal beams on which the drywall will be fastened 50 pieces needed for each section

Job scope is to fasten 1x6 boards onto the metal framing. Fasten drywall onto the 1x6s. Insulate and drywall the main support beams.

This job is a requirement imposed by the fire inspector.

The blue and yellow zones are open spaces between the roof and the ceilings over rooms in these two zones.

Total cost offer given by our local hardware/building company, BYKO, \$6,000 USD

Cost includes: Drywall, boards, insulation, and screws.